

JIANGMEN WEST-TOP LIGHTING ELECTRIC APPLIANCE CO.,LTD

ADD: #3 building, #101 Gao Xin Xi Road, Jiangmen City

Guangdong Province, China

E-mail: jeff@westoplighting.com

JEFF:+0086 13861221376



JIANGMEN WEST-TOP LIGHTING ELECTRIC APPLIANCE CO.,LTD

Engineering fund backlight panel

Model	BK-GC-595
Size	595*595
Power	48W 60W 72W 96W
Input voltage	85-265V50/60HZ
Power output voltage / current	65-85V 600MA
Type of power supply	Isolated wide pressure driver
Chip size / number of LED	2835 48pcs
Led working voltage / series parallel number	9V
Luminous angle	120°
LED power consumption / luminous flux	100LM/W



Integrated backlight panel

Model	BK-JC-6060
Size	600*600
Power	48W 60W 72W 96W
input voltage	85-265V50/60HZ
Power output voltage / current	65-85V 600MA
Type of power supply	Isolated wide pressure drive
Chip size / number of LED	2835 48pcs
Led working voltage / series parallel number	9V
Luminous angle	120°
LED power consumption/ luminous flux	100LM/W



Narrow edge backlight panel

Model	BK-EU-6060
Input voltage	220-240V50/60Hz
Power	48W 60W 72W
Power output voltage / current	30-42V1200MA
Type of power supply	CE certified power supply
Chip size/number of LED	2835 beads
Led working voltage/series parallel number	9V
Luminous angle	120°
LED power consumption / luminous flux	100LM/W
Service life of light source	50000H



RGBWW backlight panel

Model	BK-RGBWW-6060
Input voltage	220-240V50/60HZ
Power	36W 40W 48W
Power output voltage / current	30-42V1200MA
Chip size / number of LED	RGB beads +2835 beads
Type of power supply	2.4G dimming and color
Led working voltage/series parallel number	9V
Luminous angle	120°
LED power consumption / luminous flux	100LM/W
Service life of light source	50000H



American standard backlight panel

Model	BK-UL-60120
Input voltage	220-240V50/60HZ
Power	40W 48W 60W
Power output voltage / current	30-42V1500MA
Chip size / number of LED	2835 (96 pcs)
Type of power supply	UL certified
Led working voltage / series parallel number	9V
Luminous angle	120°
LED power consumption / luminous flux	100LM/W
Service life of light source	50000H



Anti glare backlight panel



Model	BK-UGR-6060
Size	600*600
Power	40W 48W 60W
Anti glare value	UGR<19
Input voltage	85-265V50/60HZ
Power output voltage/current	65-85V 600MA
Type of power supply	Isolated wide pressure
Chip size / number of LED	2835 48pcs
Led working voltage /series parallel number	9V
Luminous angle	120°
LED power consumption / luminous flux	100LM/W

Surface mounted backlight panel

Model	BK-SUR-6060
Input voltage	85-265V50/60HZ
Power	40W 48W 60W
Power output voltage / current	65-85V 600MA
Chip size / number of LED	2835 (48 pcs)
Type of power supply	Conventional
Led working voltage / series parallel number	9V
Luminous angle	120°
LED power consumption / luminous flux	100LM/W
Service life of light source	50000H



Regular side light panel

Model	CF-6060
Size	595*595
Power	40W 48W 60W 72W
Input voltage	85-265V50/60HZ
Power output voltage / current	65-85V600MA
Type of power supply	Isolated wide pressure drive
Chip size / number of LED	4014 240pcs
Led working voltage / series parallel number	3V
Luminous angle	120°
LED power consumption / luminous flux	100LM/W



Side light panel purifying lamp

Model	CF-J-6060
Size	620*620 320*620 320*1220 620*1220
Power	24W 40W 48W 60W 72W
Input voltage	85-265V50/60HZ
Power output voltage/current	65-85V600MA
Type of power supply	Isolated wide pressure drive
Chip size / number of LED	4014 240pcs
Led working voltage / series parallel number	3V
Luminous angle	120°
LED power consumption / luminous flux	100LM/W
Service life of light source	50000H

Economic fund Regular side light panel



Mode	CF-ECO-595
Size	595*595
Power	40W 48W 60W 72W
Input voltage	175-265V 50/60Hz
Power output voltage/ current	144V 300MA
Type of power supply	non-drive
Chip size / number of LED	4014 240pcs
Led working voltage / series parallel number	3V
LED power consumption/Luminous flux	100LM/W



American side light panel

Model	CF-US-605
Size	605*605 300*1200 605*1215
Power	24W 40W 48W 60W 72W
Input voltage	110-265V50/60HZ
Power output voltage/current	30-42V1200MA
Type of power supply	UL certified
Chip size / number of LED	4014 240pcs
Led working voltage / series parallel number	3V
Luminous angle	120°
LED power consumption/luminous flux	100LM/W
Service life of light source	50000H

Integrated Regular side light panel

Model	CF-JC-6060
Size	600*600
Power	40W 48W 60W 72W
Input voltage	85-265V50/60HZ
Power output voltage / current	65-85V600MA
Type of power supply	Isolated wide pressure
Chip size / number of LED	4014 240pcs
Led working voltage/series parallel number	3V
Luminous angle	120°
LED power consumption / luminous flux	100LM/W
Service life of light source	50000H



Waterproof side light panel

Model	CF-IP54-6060
Size	600*600
Power	24W 40W 48W 60W
Waterproof grade	IP54
Input voltage	85-265V50/60HZ
Power output voltage / current	65-85V600MA
Type of power supply	Isolated wide pressure
Chip size / number of LED	4014 240pcs
Led working voltage/series parallel number)	3V
Luminous angle	120°
LED power consumption / luminous flux	100LM/W
Service life of light source	50000H



surface mounted square side light panel

Model	CF-SUR-6060
Size	300*600 400*400 600*600
Power	300*1200 600*1200 24W 36W 40W 48W 60W
Input voltage	85-265V50/60Hz
Power output voltage/current	65-85V600MA
Type of power supply	Isolated wide pressure drive
Chip size / number of LED	4014 240pcs
Led working voltage / series parallel number	3V
Luminous angle	120°
LED power consumption / luminous flux	100LM/W



Model	CF-UGR-30120
Size	300*1200
Power	24W 40W 48W 60W
Anti glare value	UGR<19
Input voltage	85-265V50/60HZ
Power output voltage / current	65-85V 600MA
Type of power supply	Isolated wide pressure drive
Chip size / number of LED	4014 240pcs
Led working voltage/series parallel number	3V
Luminous angle	120°
LED power consumption / luminous flux	100LM/W
Service life of light source	50000H

surface mounted round side light panel

Size	400 500 600
Power	36W 48W
Input voltage	85-265V50/60HZ
Power output voltage/current	65-85V 600MA
Type of power supply	Isolated wide pressure drive
Chip size / number of LED	2835 240pcs
Led working voltage / series parallel number	3V
Luminous angle	120°
LED power consumption / luminous flux	100LM/W



Brazilian side light panel

Model	CF-BR-30150
Size	320*620 420*420 620*620
Power	24W 40W 48W
Input voltage	85-265V50/60Hz
Power output voltage/current	65-85V 600MA
Type of power supply	Isolated wide pressure drive
Chip size / number of LED	2835 360pcs
Led working voltage /series parallel number	3V
Luminous angle	120°
LED power consumption/luminous flux	100LM/W
Service life of light source	50000H

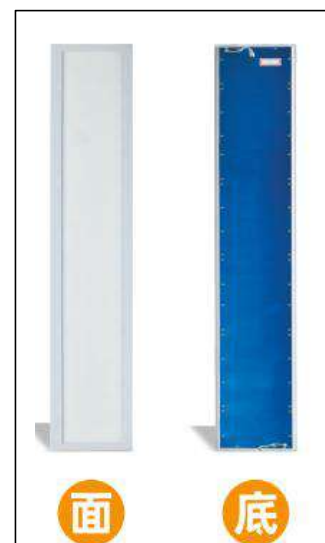

Hoisting flat lamp



数控弯圆铝框
H19W23.8 系列

Installation method hoisting and ceiling suction

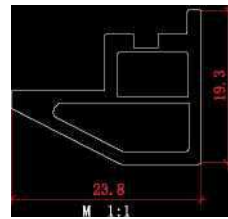

GREAT CHOICE

Product parameters

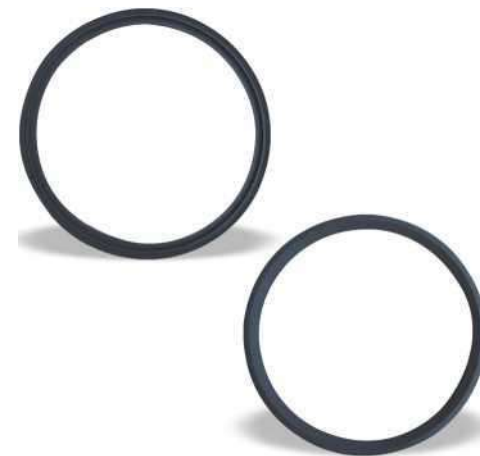
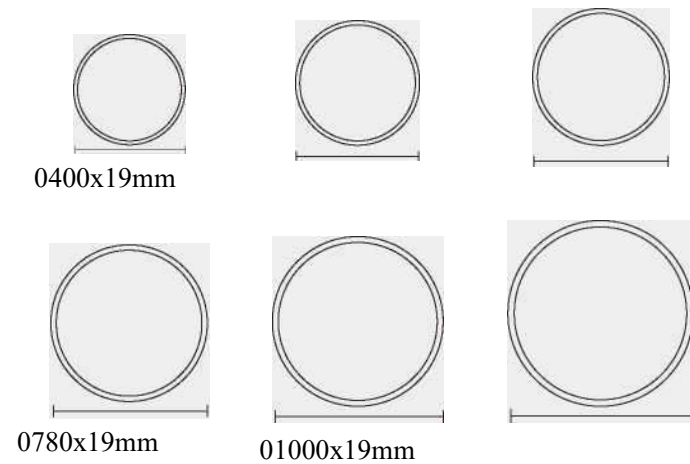

36 grid square anti glare flat lamp

Model	UGR-S36
Size	595*595
Power	48W 60W 96W120W
Anti glare value	UGR<19
Input voltage	85-265V50/60HZ
Power output voltage / current	65-85V 600MA
Type of power supply	Isolated wide pressure drive
Chip size/ number of LED	2835 144pcs
Led working voltage /series parallel number	3V
Luminous angle	120°
LED power consumption / luminous flux	100LM/W



36 grid round anti glare flat lamp



Model	UGR-R36
Size	595*595
Power	8W 60W 96W120W
Anti glare value	UGR<19
Input voltage	85-265V50/60HZ
Power output voltage / current	65-85V600MA
Type of power supply	Isolated wide pressure drive
Chip size / number of LED	2835 72pcs
Led working voltage/series parallel number	6V
Luminous angle	120°
LED power consumption / luminous flux	100LM/W

25 grid square anti glare flat lamp

Model	UGR-S25
Size	595*595
Power	8W 60W 96W 120W
Anti glare value	UGR<19
Input voltage	85-265V50/60Hz
Power output voltage / current	65-85V 600MA
Type of power supply	Isolated wide pressure drive
Chip size / number of LED	2835 600pcs
Led working voltage /series parallel number	3V
Luminous angle	120°
LED power consumption / luminous flux	100LM/W



Frame panel

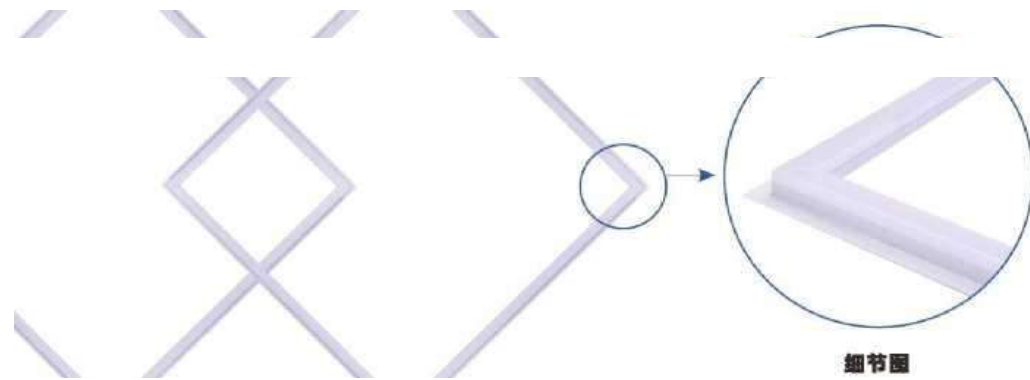

Light Source:SMD2835
 Material:Aluminum + PC
 Ra>80
 CCT: □3000K □4000K □6000K □8000K □10000K
 Driver: □ Isolated driver 85-265V
 □ No-Isolated driver 85-265V
 □ No-Isolated driver 175-265V
 □ Dimming power driver

Model	FR-3060	FR-6060	FR-30120	FR-60120
Power	36W	48W	48W	60W
Texture of material	ALU+PC	ALU+PC	ALU+PC	ALU+PC
Product size	295*595	595*595	295*595	595*1195
Drive type	Isolated driver	Isolated driver	Isolated driver	Isolated driver
Input voltage	85-265V	85-265V	85-265V	85-265V
Packing method	10pcs/box(double inner)	10pcs/box(double inner)	10pcs/box(double inner)	10pcs/box(double inner)
Outer box size	63*20*32	63*20*63	123*20*33	123*20*63

Grille panel

Model	KYD-SSD-F-96+48	KYD-4-GS-F-120
Product size	595*595*45MM	595*595*23MM
Input Voltage	AC165-265V 50HZ/60HZ	AC165-265V 50HZ/60HZ
Power output voltage/current	148V/900MA	144V/410MA*2
Type of power supply	Non isolated	Non-isolated
Chip size / number of LED	3V0.5WX576PCS/2835	3V0.5WX576PCS/2835
Led working voltage/ series parallel number	2835/6V1W/24 3 *2	24 4*2
LED power consumption / luminous flux	96W + 48W/15000LM	120W/13000LM
Outer box packaging	620*249*625MM	620*280*625MM
Weight	12.5kg	18kg



Model	KYD-MTX-F-96	KYD-YY-F-96
Product size	595*595*25MM	595*595*25MM
Input Voltage	AC165-265V 50HZ/60HZ	AC165-265V
Power output voltage/current	149V/300MA*2	149V/300MA*2
Type of power supply	Non isolated	Non isolated
Chip size / number of LED	6V1 WX144PCS/2835	6V1WX144PCS/2835
Led working voltage/series parallel number	3 and 24 string (2)	3 and 24 string (2)
LED power consumption / luminous flux	96W/11000LM	96W/11000LM
Outer box packaging	620*280*625MM	620*280*625MM
Weight	19.5 kg	20.5 kg



	<u>Anti glare UFO lamp</u>	
Model	UFO-24W	UFO-36W
Size	185	210
Anti glare value	UGR<19	UGR<19
Lighting effect)	>100LM/W	>100LM/W
Input voltage	85-265V50/60HZ	85-265V50/60HZ
Power output voltage / current	65-85V300MA	45-65V600MA
Type of power supply	Non-isolated	Non-isolated
Chip size / number of LED	2835 120pcs	2835 120pcs 0.5w
Led working voltage / series parallel number	3V	3V
Luminous angle	120°	120°



	<u>Borderless panel light</u>	
Model	WBK-R-36W	WBK-S-36W
Input voltage	175-265V50/60HZ	175-265V50/60HZ
Power output voltage/current	130-170V 300MA	130-170V 300MA
Type of power supply	Non-isolated	Non-isolated
Chip size/ number of LED	2835 252pcs 0.2W	2835 350pcs 0.2W
Led working voltage / series parallel number	3V	3V
Luminous angle	120°	120°



Anti glare panel lamp

Model	UGR-18W
Size	220
Anti glare value	UGR<19
Lighting effect	>100LM/W
Input voltage	85-265V50/60HZ
Power output voltage / current	45-65V300MA
Type of power supply	Non-isolated
Chip size/ number of LED	2835 90pcs
Led working voltage/ series parallel number	3V
Luminous angle	120°
LED power consumption/ luminous flux	100LM/W



Conventional small panel lamp



Three proof ceiling lamp

Name	230/ ceiling lamp	400 /ceiling lamp	400 /ceiling lamp
Power	15W	36W	24W+24W
Luminous flux LM	1455	3589	3589LM
Light efficiency LM /W	92LM/W	92LM/W	92LM/W
Demonstrative ra	80	80	80
Lamp beads	2835/9V1.5W/1 B/1 5C	2835/9V1.5W/2B/20C	2835/9V1.5W/2B/12C*2
Single net weight kg	0.29	0.623	0.623
Overall dimension mm	Right angle(233*45)	Right angle(375*46)	Right angle(375*46)
Shell color	Spray white	Spray white	Spray white
Number of case color packing (box/pcs)	30	20	20
Color box size (mm)	238*45*238	380*45*380	380*45*380
Outer box size (CM)	73*46.5*26	77.8*50*40	77.8*50*40

Name	300/ceiling lamp	500/ceiling lamp	500/ceiling lamp
Power	24W	60W	40W+40W
Luminous flux LM	2380	5820	4000LM
Light efficiency LM / W	92LM/W	95LM/W	95LM/W
Demonstrative ra	80	80	80
Lamp beads	2835/9V1.5W/2B/12C	2835/9V1.5W/4B/20C	2B18C*2
Single net weight kg	0.425	1.064	1.064
Overall dimension mm	Right angle(298*45)	Right angle(484*51)	Right angle(484*51)
Shell color	Spray white	Spray white	Spray white
Number of case color packing (box /pcs)	20	10	10
Color box size (mm)	303*45*303	489*51*489	489*51*489
Outer box size (CM)	62*46.5*32.5	52.5*50.5*51	52.5*50.5*51



Panel accessories

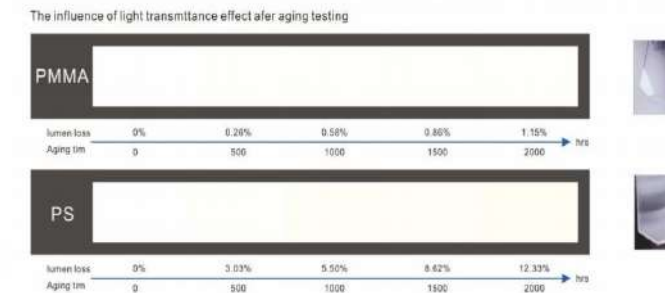

弹簧包 CLIP

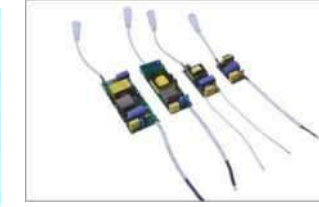

HUNG WIRE



SURFACE FRAME

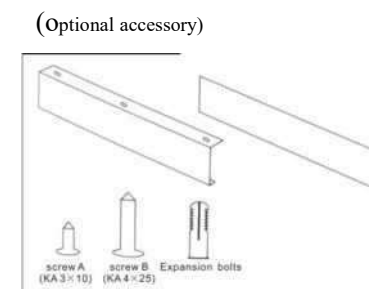

(Optional accessory)

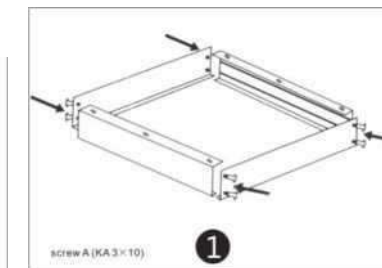

1. Assemble the four frames with Screw A to a whole square.

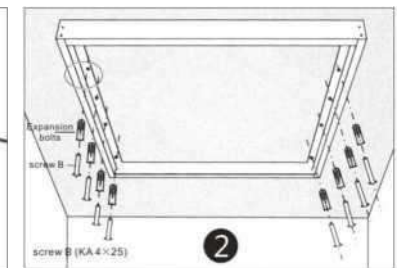

2. Fix the square frames to the ceiling with Screw B.

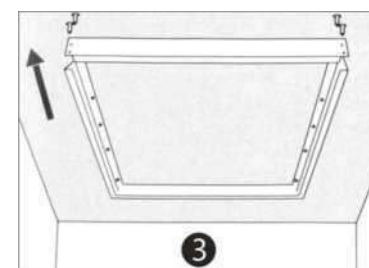

1. Demount one frame.

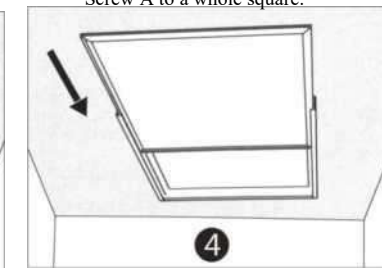

1. Put the panel into frame square.

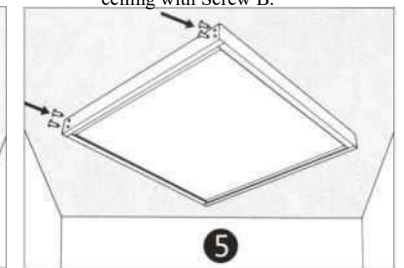

1. Fix the last frame with screw A.